



Swivel eyebold APWB grad 10



Punct de prindere rotativ cu inel, poate fi orientat in timpul incarcarii – APWB/ Grad 10

Punct de prindere rotativ cu inel, punct de fixare pivotant pentru ridicarea sarcinilor grele.

- Coeficient 4 in toate directiile de incarcare
- Proiectat, testat și certificat în conformitate cu directivele tehnice GS-MO 1504 – EN 1677
- Potrivit pentru ridicarea în condiții de siguranță, în conformitate cu Directiva Mașini 2006/42/CE
- Testat la 100% magnaflex
- Testat la 20.000 cicluri
- la cerere, filet non-standard și lungime tija
- Poate fi orientat la 360° cu auto alinierea inelului rabatabil la 180°
- Montate cu inele sferice pentru a face orientarea la ridicare mai usoara
- La tragerea axiala poate fi o variatie de + / -5° cu o scadere de 10% a capacitatii
- Nu sunt potrivite pentru rotire continua in timpul ridicarii

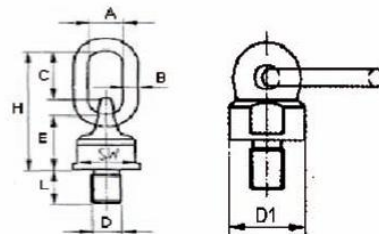

DATE TEHNICE

Turning eyebolt needed to lift loads to assemble to the load itself with specific threaded hole.

- Coefficient 4 in all loading directions
- Designed, tested and certified in compliance with the technical directives GS-MO 1504 – EN 1677
- Suitable for safe lifting in compliance with the machinery directive 2006/42/EC
- Tested at 100 % magnaflex
- Tested at 20.000 stress cycles
- Non standard threading and stem length upon request
- Can be oriented at 360° with self aligning tilting ring at 180°
- Assembled with spheres to make load orientation easier
- On the axial pull there can be variation of +/-5° with a 10% decrease in capacity



Not suitable for continuous rotation movement during loading

Maße / Measurements

Artikel Article	Abmessung DxL Size DxL	A	B	C	E	H	SW	D1	Gewicht ca. kg Weight approx.
31716931	1,4 t – M 16 x20	30	13	46	50	105	30	38	0,530
31720931	2,5 t – M 20 x30	34	16	57	50	105	30	38	1,050
31724931	4,0 t – M 24 x30	40	19	70	50	105	30	38	1,630
31736931	6,7 t – M 36 x54	40	20	65	50	105	30	38	2,230

Tragfähigkeiten / WLLs



Artikel Article	Abmessung DxL Size DxL	0° 1Strang Single leg	0° 2Stränge 2 legs	90° 1Strang Single leg	90° 2Stränge 2 legs	0°-45°	45°-60° 2Stränge 2 legs	Asym.	0°-45°	45°-60° 4Stränge 4 legs	Asym.	Drehmoment Tightening couple Nm
31716931	1,4 t – M 16 x20	2,8	5,6	1,4	2,8	2,00	1,4	1,4	3,0	2,12	1,4	70
31720931	2,5 t – M 20 x30	5,0	10,0	2,5	5,0	3,55	2,5	2,5	5,3	3,75	2,5	135
31724931	4,0 t – M 24 x30	8,0	16,0	4,0	8,0	5,60	4,0	4,0	8,0	6,00	4,0	230
31736931	6,7 t – M 36 x54	13,4	26,8	6,7	13,4	9,50	6,7	6,7	14,0	10,00	6,7	814

Total Race Impex SRL J40/20761/2006 , RO 19794573 , Bucuresti, sector 6 , Bulevardul Uverturii , nr.69A, cod:060933 Mobil:0728305610/ 0728305611 / 0728305612; fax: 0214301206;tel/fax :0314201202 E-mail:info@totalrace.ro;vanzari@totalrace.ro

Website:www.totalrace.ro , www.lanturideridicare.ro , www.chingimacarale.ro, www.benziambalare.ro, www.banadaancorare.rowww.lanturichingi.ro , www.carligemacarale.ro , www.echipamentemacara.ro, www.benebeton.ro, www.clestiridicare.ro .